

# VANTAGE ASHBURN CAMPUS

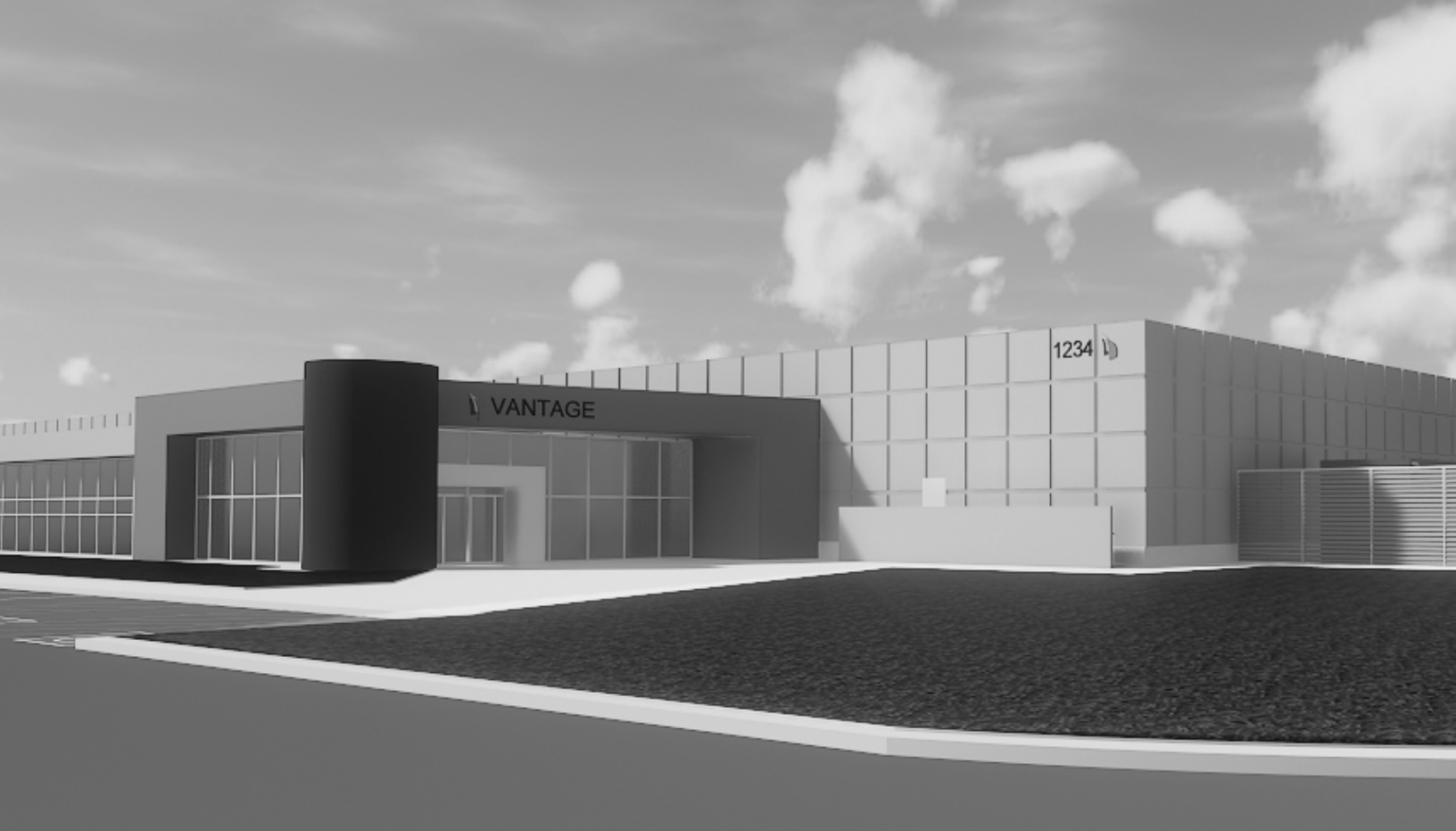

42 ACRES. 5 DATA CENTERS. VANTAGE HAS GONE NATIONAL.

## CAMPUS OVERVIEW

- 42-acre campus
- Five (5) two-story data centers planned
- First data center: 24 MW of capacity
- 720,000 sq. ft. of data center space
- 108 MW of planned critical IT load
- Located less than 2 miles from MAE-East interconnection hub
- Complete campus design with Class-A amenities, including premier office space, conference rooms, and facilities

## WHY VANTAGE

- Customization comes standard – without delaying your time-to-market
- Our data centers are designed with radical efficiency and low TCO in mind
- We're obsessive about transparency, service, and performance